

State of Wyoming Corner Record

(In compliance with the *CORNER PERPETUATION AND FILING ACT*, Wyoming Statutes, 1997 Section 33-29-140 et. seq., and the Rules and Regulations of the Board of Professional Engineers and Professional Land Surveyors)

Reverse side of this form may be used if more space is needed.

Record of original survey and citation of source of historical information (if corner is lost or obliterated). Description of corner monumentation evidence found and/or monument and accessories established to perpetuate the location of this corner. Sketch of relative location of monument, accessories, and reference points with course and distance to adjacent corner(s) (if determined in this survey). Method and rationale for reestablishment of lost or obliterated corner.

RECORD: SEE GLO NOTES.

FND: 5/8" REBAR FLUSH IN INTERSECTION OF BEAR CREEK RD AND SOUTH CHUGWATER HIGHWAY.

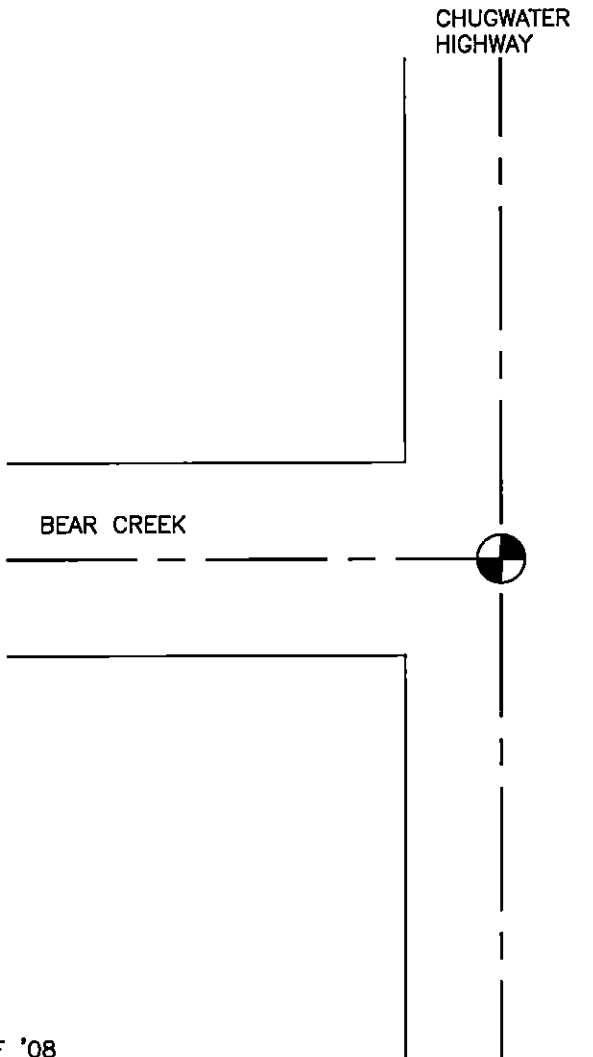

TO W
1/4
COR.
SEC.
36

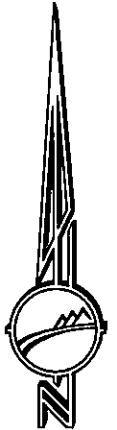
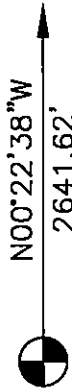

ITRF '08
LAT- 41°39'12.7"N
LONG- 104°50'45.9"W
PLATTE COUNTY, WYO
SEARCH VALUES ONLY

BEARINGS AND DISTANCES ARE GRID.
WYO. STATE PLANE, EAST ZONE.

NO SCALE

Date of Field Work: 4-7-16 Office Reference: W.O.# 15967-02 FB# 1306 PG# 23 PT# 500 INT. AJM

Cross Index Plat

	1	2	3	4	5	6	7	8	9	10	11	12	13	14	15	16	17	18	19	20	21	22	23	24	25
A																									
B																									
C		6	5	4	3	2	1																		
D																									
E																									
F																									
G		7	8	9	10	11	12																		
H																									
J																									
K																									
L		18	17	16	15	14	13																		
M																									
N																									
O																									
P		19	20	21	22	23	24																		
Q																									
R																									
S																									
T		30	29	28	27	26	25																		
U																									
V																									
W																									
X		31	32	33	34	35	36																		
Y																									
Z																									

Firm/Agency, Address

Andrew Minton
WLC
200 PRONGHORN
CASPER, WY 82601
Telephone Number: 307-266-2524

This corner record was prepared by me or under my direction and supervision.

SEAL & SIGNATURE

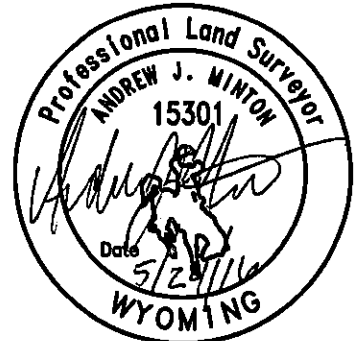

RECP #: 690767
RECORDED 8/23/2016 AT 10:09 AM BK# 2513 PG# 1365
Debra K. Lee, CLERK OF LARAMIE COUNTY, WY PAGE 1 OF 1

Corner Name NW Corner Section 1, T 19 N, R 67 W, 6th P.M.
County: LARAMIE Wyoming

Cross-Index No.: A-21